

		Conditions
cell type:	NiMH	
cell size:	AA	
nominal voltage:	1.2 V	
max. charge voltage:	1.5 V	at standard charge (0.1C / 20°C)
capacity		
nominal:	2850 mAh	discharge at 0.2C
minimum:	2650 mAh	discharge at 0.2C
	2400 mAh	discharge at 1C
		1.0V end discharge voltage
		ta: 20°C
max. continuous discharge current:	5000 mA	ta: 0...45°C
charge		
standard charge:	current 265 mA	time 14...16hrs
quick charge:	750 mA	4hrs
fast charge:	2650 mA	1.1hr
recommended charge termination control parameters:	0...5 mV 0.8...1 °C 45...50 °C	- ΔV (-deltaV) temperature rise per minute TCO (temperature cut off)
trickle charge current:	10...30 mA	(recommended)
continuous overcharge: (less than 1 year)	≤ 100 mA	no conspicuous deformation no leakage
internal resistance: (impedance)	≤ 35 mΩ	at 1KHz battery fully charged
life expectancy:	≥ 500 cycles	acc. IEC standard
self discharge		
charge retention after 360 days storage at 20°C:	≥ 40 %	of minimal battery capacity; at 0.2C discharge to EV 1.0V
subsequent capacity:	≥ 1060 mAh	
initial capacity:	≥ 2000 mAh	within 30 days after delivery discharge at 0.2C
ambient temperature range:	0...45 °C 10...40 °C - 20...65 °C - 20...50 °C - 20...45 °C - 20...35 °C	standard charge fast charge discharge storage (≤1month) storage (≤6months) storage (≤12months)

Diagrams

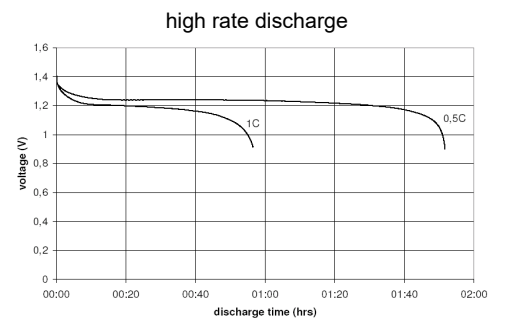
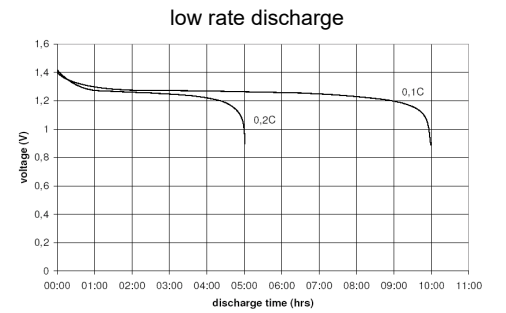
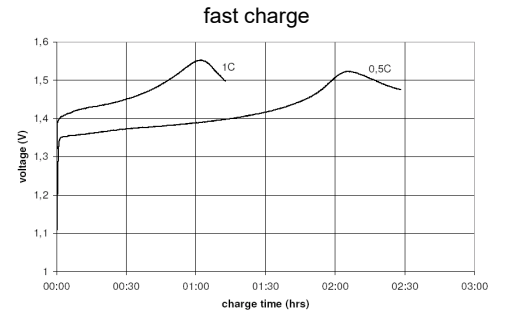
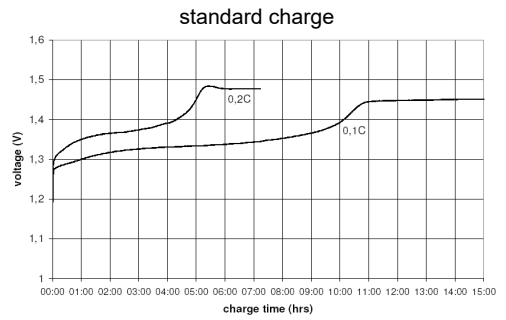

QCT1:	20/2500/40
QCT2:	30/2350/45

mechanical specifications

cell dimensions		
diameter d1 (incl. label):	14.5 - 0.7	mm
diameter d1 (bare cell):	14.3 - 0.7	mm
diameter d2:	max. 5.5	mm
height h1:	50.5 - 0.5	mm
height h2:	min. 1.2	mm
weight:	31 ± 2	g

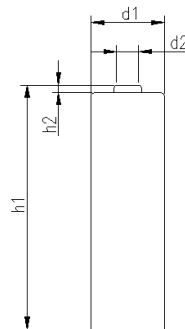

	ANSMANN Specifications for model:	NiMH Battery
		AA - 2850mAh reduced self discharge
	data sheet no. / part no.	
	supplier no.	701372
author / date	TG / 17.12.2019	