



Retiring ramp ELB - Kompakt SHL Special

Reference: Installation manual Retiring ramp ELB- Kompakt SHL-Special 2500431

ELB Kompakt SHL-Special is motor activated retiring ramp. The ramp falls in the event of power failure, powered with 24VDC. The slim design makes it suitable for lifts with narrow shafts or locks with bevel-gear mechanism.

Contents of packaging

1. Retiring ramp
2. Screw kit for mounting
3. Motor kit (2500423) incl mounting kit.

Recommended tools

Screwdriver – Torx 20 & Flat

1. Mounting of retiring ramp with motor kit

The Retiring ramp is assembled together with the motor kit with screws and spacer Studs. Then the chain from the motor is connected to the retiring ramp by removing the chain lock with the flat chisel or equivalent Figure 1(a). To dampen the sound from vibrations, PVC oval grommets are included for the holes together with flat washers. Motor kit is placed as close as possible to the locking roller. Keep in mind that the direction of rotation of the motor can be adjusted to suit the location. Depending on the car roof, the holes can be drilled and threaded or screwed according to "5. Dimensions" .

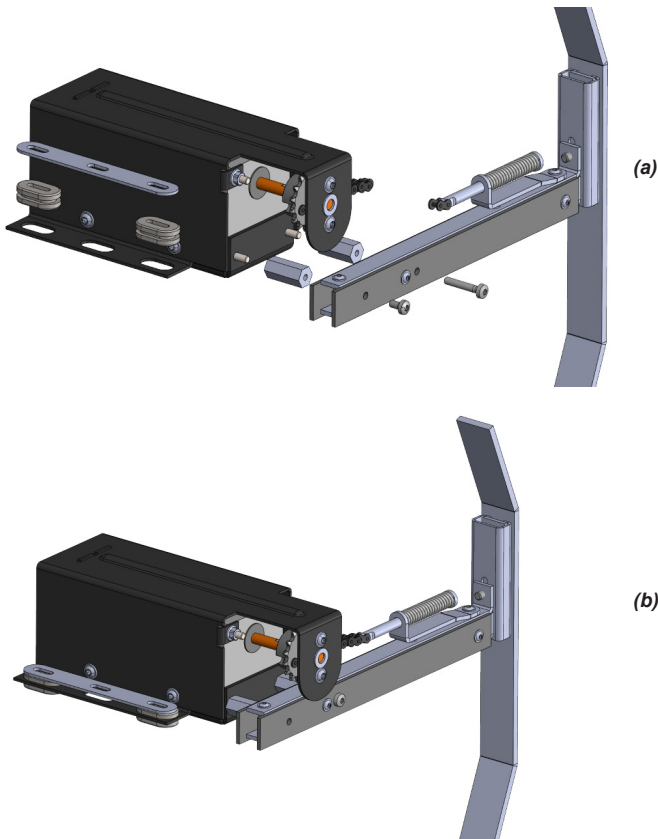
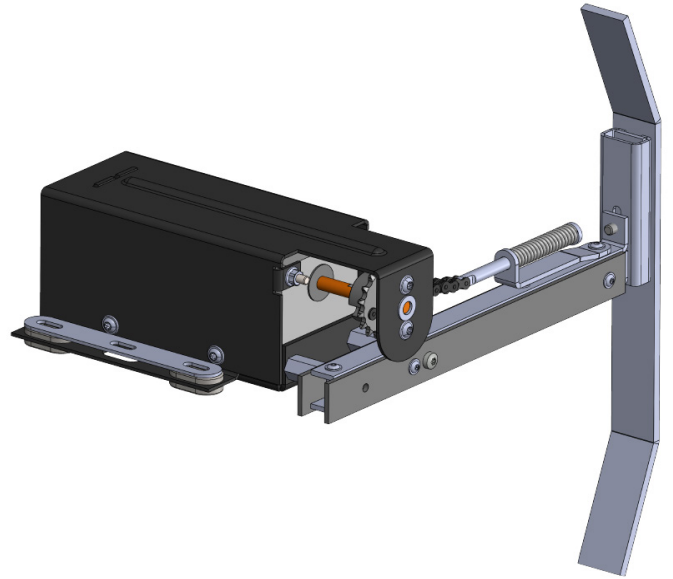

Figure 1 Mounting of retiring ramp

2. Connections

Note: see eventual risks in Sec.3 before connecting

Motor kit comes with a cable that is connected to 24V DC. Minimum 2,5A is needed to be able to pull it all the way. Red to positive (+) and black to negative (-).



ELB-kompakt SHL - Special

3. Risk of squeezing

There are two zones of squeezing risk, one is between the retiring ramp's ramp and its base plates during active retraction. The second is on the motor between gear and chain. we suggest to be very cautious while working/ service in these areas, make sure power supply is switched off to avoid risks involved.

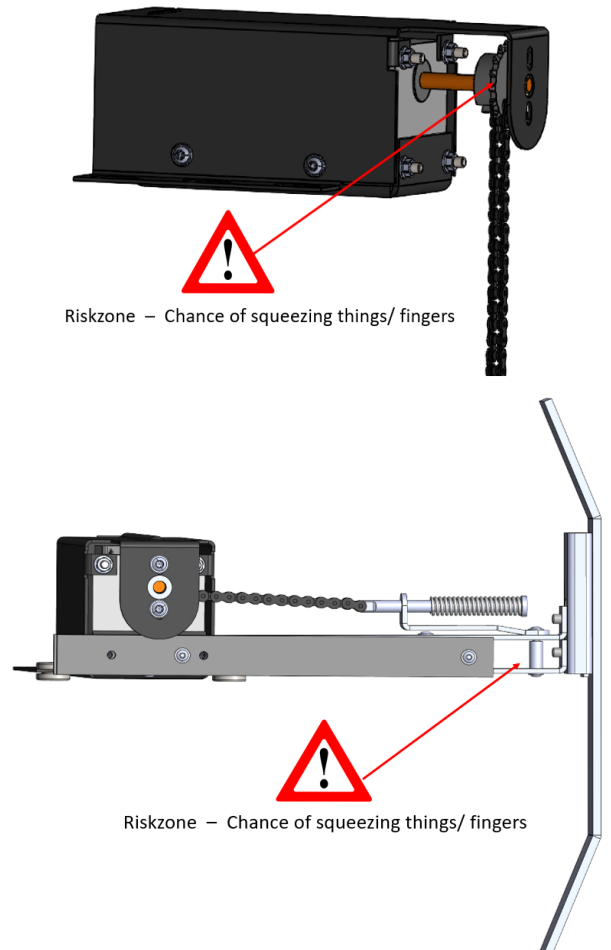

Figure 2 Illustrating the squeeze risk zone one & two