



PS216-T12-N200

- Lever angle adjustable in 15° steps
- Simple and quick to adjust the control elements by 45°.
- thermoplastic enclosure with foldable latching cover
- Quick connection technology as connection terminals rotated by 45°
- cable entry 1 x M20 x 1,5
- Design to EN 50047
- length adjustable in 2 mm steps
- LED version available

Data

Approvals - Standards

Certificates	cULus CCC
--------------	--------------

General data

Standards	EN IEC 60947-5-1
Housing construction form	Norm construction design
Actuator type to EN 50047	A
Enclosure material	Plastic, glass-fibre-reinforced
Gross weight	136 g

General data - Features

Safety functions	Yes
Number of auxiliary contacts	1
Number of safety contacts	2

Safety classification

Mission time 20 Year(s)

Safety classification - Safety outputs

B_{10D} Normally-closed contact (NC) 20,000,000 Operations

Mechanical data

Actuating element Roller lever N200
Position of the cable gland bottom
Mechanical life, minimum 10,000,000 Operations
Positive break force, minimum 40 N
Actuating speed, minimum 60 mm/min
Actuating speed, maximum 1 m/s
Tightening torque of the fixing screws 1.2 Nm

Mechanical data - Connection technique

Termination Screw terminals M20 x 1.5
Cable section, minimum 0.34 mm²
Cable section, maximum 1.5 mm²
Tightening torque of electrical connection, minimum 0.6 Nm
Tightening torque of electrical connection, maximum 0.8 Nm

Mechanical data - Dimensions

Length of sensor 32.5 mm
Width of sensor 31 mm
Height of sensor 150.5 mm

Ambient conditions

Degree of protection	IP67 IP66
Ambient temperature	-30 ... +80 °C
Protection class	II

Ambient conditions - Insulation values

Rated insulation voltage U_i	250 VAC
Rated impulse withstand voltage U_{imp}	4 kV
Degree of pollution	3

Electrical data

Thermal test current	5 A
Required rated short-circuit current	400 A
Utilisation category AC-15	240 VAC
Utilisation category AC-15	3 A
Utilisation category DC-13	24 VDC
Utilisation category DC-13	3 A
Switching element	1 NO contact, 2 NC contacts
Switching principle	Slow action
Switching frequency	5,000 /h
Material of the contacts, electrical	Silver

Ordering code

Product type description:
PS2(2)-(3)-(4)-(5)-(6)-(7)-(8)-(9)-(10)-(11)-(12)

(1)

without	non-EX version
EX	Types of protection Ex d and t, to Zone 1/21
EXI	Types of protection Ex i and t, up to Zone 1/21

(2)

215	Metal enclosure
216	Thermoplastic enclosure
226	Plastic housing with 2 cable entries
(3)	
without	L-hole (standard)
L	elongated hole
(4)	
Z11	Snap action 1 NO contact / 1 NC contact
Z02	Snap action 2 NC contacts
Z12	Snap action 1 NO contact / 2 NC contact
Z11R	Snap action 1 NO contact / 1 NC contact with latching
Z01R	Snap action 1 NC contact with latching
Z02R	Snap action 2 NC contacts with latching
T11	Slow action 1 NO contact / 1 NC contact
T02	Slow action 2 NC contacts
T20	Slow action 2 NO contact
T12	Slow action 1 NO contact / 2 NC contact
T21	Slow action 2 NO contact / 1 NC contact
T03	Slow action 3 NC contacts
T11UE	Slow action 1 NO contact / 1 NC contact with overlapping contacts
T02H	Slow action 2 NC contacts with staggered contacts
T11K	Slow action 1 NO contact + 1 NC contact - short-stroke
T10	Slow action 1 NO contact
T02K	Slow action 2 NO contacts short-stroke
T20H	Slow action 2 NO contacts staggered
(5)	
without	Contacts silver plated (Standard)
A1	Gold contacts 0,3 µm
A2	Gold contacts 1,0 µm
A3	Gold contacts 3,0 µm

(6)

without

without indication light

G

integrated status display

(7)

without

Cable entry M20

M16

cable entry M16

ST

Connector plug M12 - plastic - bottom

STR

Connector plug M12, right

STL

Connector plug M 12, left

STM

Connector plug M12, metal

(8)

S200

plunger S200 Ø 6 mm

S210

Plunger Ø 8,6 mm

S211

Plunger Ø 10,3 mm

S221

Plunger Ø 9,8 mm

R200

Roller plunger R200

R201

Roller plunger - stainless steel roller Ø 9,5mm

R210

Roller plunger - plastic roller Ø 12mm

K201

Roller plunger - stainless steel roller - width 5,3 mm - Ø 12mm

K200

Offset roller lever - plastic roller- width 5.3 mm - Ø 12 mm

K201

Roller plunger - stainless steel roller - width 5,3 mm - Ø 12mm

K210

Offset roller lever - plastic roller- width 5mm - Ø 14mm

K211

Offset roller lever - stainless steel roller - width 5mm - Ø 14mm

K220

Offset roller lever - plastic roller- width 7.6 mm - Ø 14 mm

K230

Angle roller lever - plastic roller Ø 14 mm

K231

Roller plunger - stainless steel roller Ø 14mm
(Standard)

K240

Angle roller lever with plastic roller Ø 22 mm - right-bent

K250	Angle roller lever with plastic roller Ø 22 mm - left-bent
H200	Roller lever - plastic roller Ø 16 m - lever length 24 mm
H202	Roller lever - brass roller Ø 16mm - lever length 24mm (Standard)
H230	Roller lever - plastic roller Ø 16mm - lever length 28 mm
H232	Roller lever - brass roller Ø 16mm - lever length 28 mm
H236	Roller lever - rubber roller Ø 16mm - lever length 28 mm
N200	Roller lever 2 mm Toothing (24...26mm) - Plastic roller Ø 20 mm - Width 9.8 mm
N201	Roller lever adjustable in 2 mm steps (24...66mm) - stainless steel roller Ø 20mm - width 9,8 mm
N202	Roller lever - adjustable in 2 mm steps (24...66mm) - brass roller Ø 20mm - width 9,8 mm
N206	Roller lever - adjustable in 2 mm steps (24...66mm) - rubber roller Ø 50mm - width 16 mm
N210	Roller lever - adjustable in 2 mm steps (24...66mm) - plastic roller Ø 20mm - width 4 mm - long- angled - locking washer
N280	Roller lever -adjustable in 2 mm steps (24...66mm) - plastic roller Ø 20mm - width 5 mm - long - locking washer
J200	Rod lever - plastic - 200mm -Ø 6mm
J201	Rod lever - stainless steel - 200mm -Ø 6mm (Standard)
J203	Rod lever - aluminium - 200mm -Ø 6mm
F230	Spring rod - stainless steel - 150.4 mm
F231	Spring rod - stainless steel - 70.2 mm
A200	Special actuating bolt - plastic - valve control

(9)

without	no intent rotation (Standard)
U1	intent rotation 45°
U2	intent rotation 90°
U3	intent rotation 135°
U4	intent rotation 180°
U5	intent rotation 225°

U6 intent rotation 275°

U7 intent rotation 315°

(10)

without no lever rotation (Standard)

X1 lever rotation 15°

X2 lever rotation 30°

X3 lever rotation 45°

X4 lever rotation 60°

X5 lever rotation 75°

X6 lever rotation 90°

X7 lever rotation 105°

X8 lever rotation 120°

X9 lever rotation 135°

X10 lever rotation 150°

X11 lever rotation 165°

X12 lever rotation 180°

X13 lever rotation 195°

X14 lever rotation 210°

X15 lever rotation 225°

X16 lever rotation 240°

X17 lever rotation 255°

X18 lever rotation 270°

X19 lever rotation 285°

X20 lever rotation 300°

X21 lever rotation 315°

X22 lever rotation 330°

X23 lever rotation 345°

(11)

without Roller outside (Standard)

I Roller inside

(12)

without

-30...+80°C (Standard)

T

-40...+80°C

(13)

(14)

without

Zone 2 and 22

3GD

Zone 2 and 22

2D

Zone 21

3D

Zone 22

Pictures

Product picture (catalogue individual photo)



ID: kps2nf02

| 1,2 MB | .jpg | 352.778 x 1026.936 mm - 1000 x 2911 px - 72 dpi

| 89,2 kB | .png | 74.083 x 215.547 mm - 210 x 611 px - 72 dpi

Dimensional drawing basic component

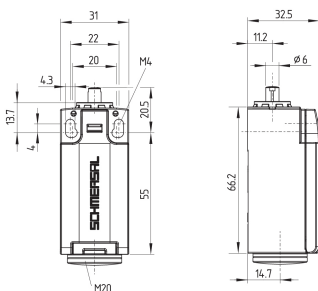

ID: kps2xg12

| 125,8 kB | .jpg | 352.778 x 315.031 mm - 1000 x 893 px - 72 dpi

Dimensional drawing actuator

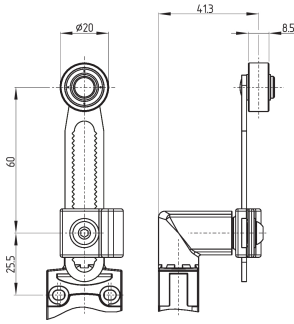

ID: kps11b10

| 445,4 kB | .ai | 141.812 x 138.775 mm - 401 x 393 px - 72 dpi

| 13,7 kB | .png | 74.083 x 72.672 mm - 210 x 206 px - 72 dpi

| 195,0 kB | .jpg | 352.778 x 383.469 mm - 1000 x 1087 px - 72 dpi

Switch travel diagram

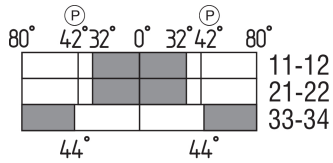

ID: kps11s61

| 2,3 kB | .png | 74.083 x 36.689 mm - 210 x 104 px - 72 dpi

| 84,8 kB | .jpg | 352.778 x 173.919 mm - 1000 x 493 px - 72 dpi

Diagram

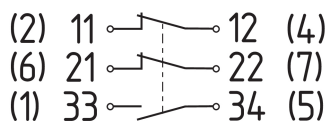

ID: kps2xk02

| 80,7 kB | .jpg | 352.778 x 148.167 mm - 1000 x 420 px - 72 dpi

| 3,6 kB | .png | 74.083 x 31.044 mm - 210 x 88 px - 72 dpi

Schmersal Nordiska AB, F O Petersons gata 28, S-421 31 Västra Frölunda

The details and data referred to have been carefully checked. Images may diverge from original. Further technical data can be found in the manual. Technical amendments and errors possible.

Generated on: 29/05/2023, 07:24