



## PS216-Z02-K230

- thermoplastic enclosure with foldable latching cover
- Quick connection technology as connection terminals rotated by 45°
- Simple and quick to adjust the control elements by 45°.
- cable entry 1 x M20 x 1,5
- Design to EN 50047
- Actuation from bottom parallel to the switch, therefore only suitable for small housings.
- LED version available

## Data

### Approvals - Standards

Certificates	cULus CCC
--------------	--------------

### General data

Standards	EN IEC 60947-5-1
Housing construction form	Norm construction design
Enclosure material	Plastic, glass-fibre-reinforced
Gross weight	190 g

### General data - Features

Safety functions	Yes
Number of safety contacts	2

### Safety classification

Mission time	20 Year(s)
--------------	------------

## Safety classification - Safety outputs

B<sub>10D</sub> Normally-closed contact (NC) 20,000,000 Operations

## Mechanical data

Actuating element Angle roller lever K230  
Position of the cable gland bottom  
Mechanical life, minimum 10,000,000 Operations  
Positive break force, minimum 40 N  
Actuating speed, minimum 10 mm/min  
Actuating speed, maximum 1 m/s  
Tightening torque of the fixing screws 1.2 Nm

## Mechanical data - Connection technique

Termination Screw terminals M20 x 1.5  
Cable section, minimum 0.34 mm<sup>2</sup>  
Cable section, maximum 1.5 mm<sup>2</sup>  
Tightening torque of electrical connection, minimum 0.6 Nm  
Tightening torque of electrical connection, maximum 0.8 Nm

## Mechanical data - Dimensions

Length of sensor 32.5 mm  
Width of sensor 31 mm  
Height of sensor 93.5 mm

## Ambient conditions

Degree of protection IP67  
IP66  
Ambient temperature -30 ... +80 °C  
Protection class II

## Ambient conditions - Insulation values

Rated insulation voltage $U_i$	250 VAC
Rated impulse withstand voltage $U_{imp}$	4 kV
Degree of pollution	3

## Electrical data

Thermal test current	10 A
Required rated short-circuit current	400 A
Utilisation category AC-15	240 VAC
Utilisation category AC-15	3 A
Utilisation category DC-13	24 VDC
Utilisation category DC-13	3 A
Switching element	2 NC contact
Switching principle	Snap action
Switching frequency	5,000 /h
Material of the contacts, electrical	Silver

## Pictures

### Product picture (catalogue individual photo)



ID: kps2kf08

| 733.0 kB | .jpg | 352.778 x 664.633 mm - 1000 x 1884 px - 72 dpi

| 49.6 kB | .png | 74.083 x 139.347 mm - 210 x 395 px - 72 dpi

### Dimensional drawing basic component

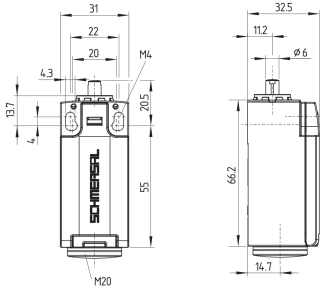

ID: kps2xg12

| 125.8 kB | .jpg | 352.778 x 315.031 mm - 1000 x 893 px - 72 dpi

## Dimensional drawing actuator

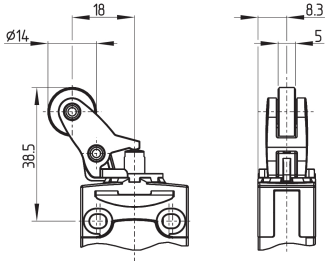

ID: kps11b06

| 320.2 kB | .ai | 126.159 x 104.899 mm - 357 x 297 px - 72 dpi

| 4.1 kB | .png | 74.083 x 61.736 mm - 210 x 175 px - 72 dpi

| 150.0 kB | .jpg | 352.778 x 290.689 mm - 1000 x 824 px - 72 dpi

## Switch travel diagram

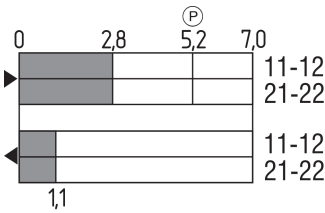

ID: kps11s29

| 2.2 kB | .png | 74.083 x 47.625 mm - 210 x 135 px - 72 dpi

| 73.1 kB | .jpg | 352.778 x 226.483 mm - 1000 x 642 px - 72 dpi

## Diagram

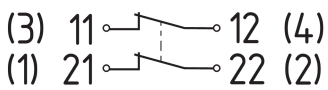

ID: kps2xk08

| 56.1 kB | .jpg | 352.778 x 110.067 mm - 1000 x 312 px - 72 dpi

| 2.6 kB | .png | 74.083 x 22.931 mm - 210 x 65 px - 72 dpi

K.A. Schmersal GmbH & Co. KG, Möddinghofe 30, 42279 Wuppertal

The details and data referred to have been carefully checked. Images may diverge from original. Further technical data can be found in the manual. Technical amendments and errors possible.

Generated on: 29/05/2023, 06:47