

Removable bridge safety contact, self-cleaning contacts. Protectors are provided for wiring with double insulation cable, max diameter 6.6mm and with normal cables up to 4mm diameter. Fastening screws are included. The standard model uses SH+M4x10 screws which protrude externally by 4mm. Other screws are available on demand. The A2 version offers the option to run cables underneath the contact body to achieve seal after fastening.

Contatto di sicurezza a ponte asportabile, contatti autopulenti, per il cablaggio sono previste protezioni per cavi a doppio isolamento di diametro max 6,6 mm e per cavi normali fino a 4 mm di diametro. Le viti di fissaggio sono incluse, il modello standard utilizza viti TC+M4x10 che fuoriescono all'esterno per 4 mm, altre viti sono disponibili a richiesta. La versione A2 offre la possibilità di passare i cavi sotto al corpo del contatto per realizzare una tenuta dopo il fissaggio.

## TECHNICAL DATA DATI TECNICI

le/Ue:	2A/230VAC 2A/200VDC
Ith	4A
Ui	500V
load classes: classi di carico:	AC-15 Ie=2A Ue=230V DC-13 Ie=2A Ue=200V
mechanical lifetime: vita meccanica:	> 10,000,000 cycles
protection level: livello di protezione:	IP 20
bridge working stroke: corsa utile del ponte:	6 mm with PA 02 18
actuation force: forza di azionamento:	< 2 N
operating temperature: temperatura di lavoro:	-25°C +65°C
cabling tightening torque: coppia di serraggio per il cablaggio:	≤ 1.7 Nm with stranded wire max section 1.5mm <sup>2</sup> con cavo a trefoli di sezione max 1,5mm <sup>2</sup>

## MATERIALS MATERIALI

body: corpo:	nylon - V0
cover: coperchio:	PC - V0
springs: molle:	stainless steel
contacts: contatti:	silver

## REGULATIONS NORMATIVE



2014/33/UE  
EN 81-20/50  
EN 60947-5-1  
GB 14048.5:2008  
2011/65/UE (ROHS)  
2003/11/EC  
UL 508  
CSA B44-13 2012-03  
ASME A17.1-2013

1.2Nm (10.6 inch-lbf) torque  
1x16 AWG to 14 AWG  
Cu wire - solid or stranded

## APPROVALS APPROVAZIONI

TÜV SÜD  
UL  
CCC

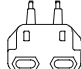
## ACTUATORS AZIONATORI

PA 02		2400320 / 2400321
PA 03		2400357
PA 05		2400348

to be ordered separately  
da ordinare separatamente

## AS 03 A1

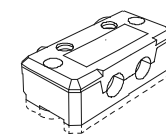
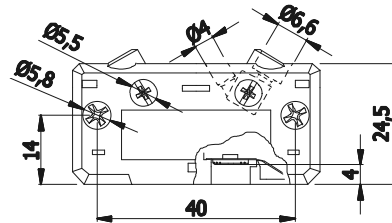
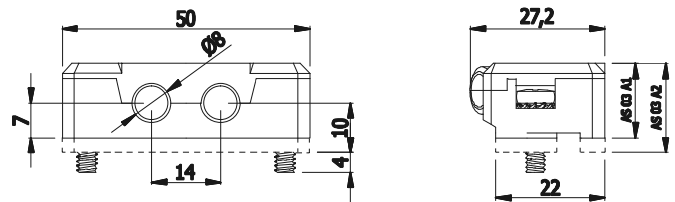

Type A1

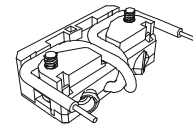

Type A2

## Available article codes:

2400351...AS03 A1 door contact  
2400349...AS03 A2 door contact  
3705045...AS03 A1 + contact bridge PA02 18mm (SET)